

General Purpose Jacks - Plain Ram, Double Acting, Oil Return

Capacity 10 - 2000 ton / Stroke 150 mm / Max. Working Pressure 700 bar



ODP Series



ODPS Series



Features / Application

- Suits most of the general lifting and push-pull applications
- Spherical saddle for 500t and above; optional for lower capacities
- Safety relief valve in return port, in case of accidental over-pressurization due to blockage in return line
- Multipurpose application, Concrete pile testing, box pushing, ship lifting and hydraulic presses

Plain Saddle



Spherical Saddle

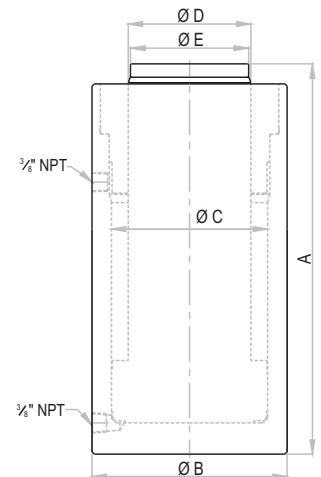

ODP Series - **O** Orione **D** Double acting Oil return **P** Plain ram **10** Capacity - ton **150** Stroke - mm

ODPS Series - **S** Spherical saddle (Tilting angle 5° Max.)

| Capacity (ton) | Capacity (kN) | Stroke (mm) | Model with Plain saddle | Model with Spherical saddle | Effective area (cm ²) | Oil cap. (cc) | Closed height (Plain saddle) A (mm) | Closed height (Spherical saddle) A (mm) | Cylinder OD B (mm) | Bore dia. C (mm) | Ram dia. D (mm) | Plain saddle dia. E (mm) | Spherical saddle dia. E (mm) | Wt. (Approx.) (Plain saddle) (kg) | Wt. (Approx.) (Sph. saddle) (kg) |
|----------------|---------------|-------------|-------------------------|-----------------------------|-----------------------------------|---------------|-------------------------------------|---|--------------------|------------------|-----------------|--------------------------|------------------------------|-----------------------------------|----------------------------------|
| 10 | 111 | 150 | ODP 10-150 | ODPS 10-150 | 15.9 | 239 | 275 | 285 | 75 | 45 | 30 | 28 | 35 | 8 | 8.2 |
| 15 | 167 | 150 | ODP 15-150 | ODPS 15-150 | 23.8 | 356 | 280 | 290 | 85 | 55 | 40 | 38 | 35 | 10.5 | 10.7 |
| 20 | 218 | 150 | ODP 20-150 | ODPS 20-150 | 31.2 | 468 | 285 | 300 | 95 | 63 | 50 | 48 | 48 | 14.2 | 14.5 |
| 25 | 270 | 150 | ODP 25-150 | ODPS 25-150 | 38.5 | 577 | 295 | 310 | 95 | 70 | 55 | 53 | 48 | 14 | 14.3 |
| 30 | 309 | 150 | ODP 30-150 | ODPS 30-150 | 44.2 | 663 | 305 | 320 | 100 | 75 | 55 | 53 | 55 | 16 | 16.5 |
| 50 | 550 | 150 | ODP 50-150 | ODPS 50-150 | 78.5 | 1178 | 305 | 320 | 130 | 100 | 70 | 67 | 74 | 26 | 27 |
| 75 | 792 | 150 | ODP 75-150 | ODPS 75-150 | 113.1 | 1696 | 305 | 330 | 155 | 120 | 90 | 87 | 88 | 36.5 | 37.5 |
| 100 | 1077 | 150 | ODP 100-150 | ODPS 100-150 | 153.9 | 2309 | 310 | 330 | 180 | 140 | 110 | 106 | 100 | 52.5 | 54 |
| 150 | 1589 | 150 | ODP 150-150 | ODPS 150-150 | 227.0 | 3405 | 320 | 345 | 220 | 170 | 140 | 137 | 130 | 85 | 87 |
| 200 | 2199 | 150 | ODP 200-150 | ODPS 200-150 | 314.2 | 4712 | 345 | 370 | 255 | 200 | 150 | 146 | 150 | 116 | 119.5 |
| 250 | 2661 | 150 | ODP 250-150 | ODPS 250-150 | 380.1 | 5702 | 350 | 385 | 280 | 220 | 180 | 177 | 165 | 148 | 153 |
| 300 | 3167 | 150 | ODP 300-150 | ODPS 300-150 | 452.4 | 6786 | 365 | 400 | 310 | 240 | 180 | 177 | 180 | 181 | 190 |
| 400 | 4008 | 150 | ODP 400-150 | ODPS 400-150 | 572.6 | 8588 | 385 | 425 | 350 | 270 | 220 | 216 | 212 | 254 | 265 |
| 500 | 4948 | 150 | - | ODPS 500-150 | 706.9 | 10603 | - | 450 | 400 | 300 | 240 | - | 230 | - | 365 |
| 600 | 5987 | 150 | - | ODPS 600-150 | 855.3 | 12829 | - | 480 | 430 | 330 | 270 | - | 260 | - | 453 |
| 800 | 7939 | 150 | - | ODPS 800-150 | 1134.1 | 17012 | - | 515 | 505 | 380 | 300 | - | 290 | - | 654 |
| 1000 | 9930 | 150 | - | ODPS 1000-150 | 1418.6 | 21279 | - | 560 | 560 | 425 | 350 | - | 330 | - | 892 |
| 1500 | 15154 | 150 | - | ODPS 1500-150 | 2164.8 | 32472 | - | 620 | 705 | 525 | 420 | - | 400 | - | 1540 |
| 2000 | 20458 | 150 | - | ODPS 2000-150 | 2922.5 | 43837 | - | 705 | 810 | 610 | 525 | - | 495 | - | 2348 |

■ Higher capacity and customized solutions on request. ■ Specifications are subject to change due to continual improvement.

■ Capacity and Stroke specified are maximum safe limits. As safe practice, use at 80% of rating.

CUSTOMISED SOLUTIONS

